



Update on Design & Construction
for

NM 128 Phases 1 & 2

CN 2104330

April 30, 2025

Virtual Public Meeting



New Mexico DEPARTMENT OF
TRANSPORTATION
MOBILITY FOR EVERYONE



U.S. Department of Transportation
**Federal Highway
Administration**

Language Access/Acceso al idioma

This meeting is available in English and Spanish. Please use the globe icon on your toolbar to select your preferred language. Even if your preferred language is English, select that now.

Esta reunión está disponible en inglés y español. Utilice el icono del globo en la barra de herramientas para seleccionar su idioma preferido. Si prefiere español, selecciónelo ahora.

Project team



Sherri Holliefield, NMDOT Project Development Engineer

Francisco Sanchez, NMDOT District 2 Engineer

Michael Smelker, NMDOT District 2 Assistant District Engineer – Construction

Jason Smith, NMDOT District 2 Environmental Coordinator



Andrew Sutliff, Project Manager

Arturo Bernal, Roadway Design Lead

Dominic Montoya, Environmental Lead

Nick Fazio, Communications & Public Involvement Lead

Agenda

Project Presentation:

- » Project presentation (~30 minutes)
 - » Background/Study recap
 - » Phase 1 Design and Construction Phasing
 - » Phase 2 Design and Construction Phasing
 - » Schedule and Next Steps
 - » How to Comment
- » Questions and Answers

Ground Rules/General Comments

- » Please be respectful of each other.
- » Please use the Zoom “Raise Hand” feature if you have a question or comment.
 - » Questions/comments will be addressed during the Q&A/Public Comment period.
 - » Please limit comments to ~3 minutes. Time permitting, we will call on you again once everyone has had an opportunity to speak.
- » This meeting will be recorded to make sure that all comments and questions have been documented.

Project Timeline

- » Start of study (Phase IA/B) – **Fall 2020**
- » Completion of study – **Summer 2022**
- » Environmental analysis/documentation **Summer 2022**
- » Obtain funding | **Summer 2025**
- » Right of Way (ROW) Acquisition
- » Construction (Phase 1) – **Start Fall 2025** **We are here**
- » Final design (Phase 2) – **Ongoing**
- » Construction (Phase 2) – **Start Early 2026**

Project Map

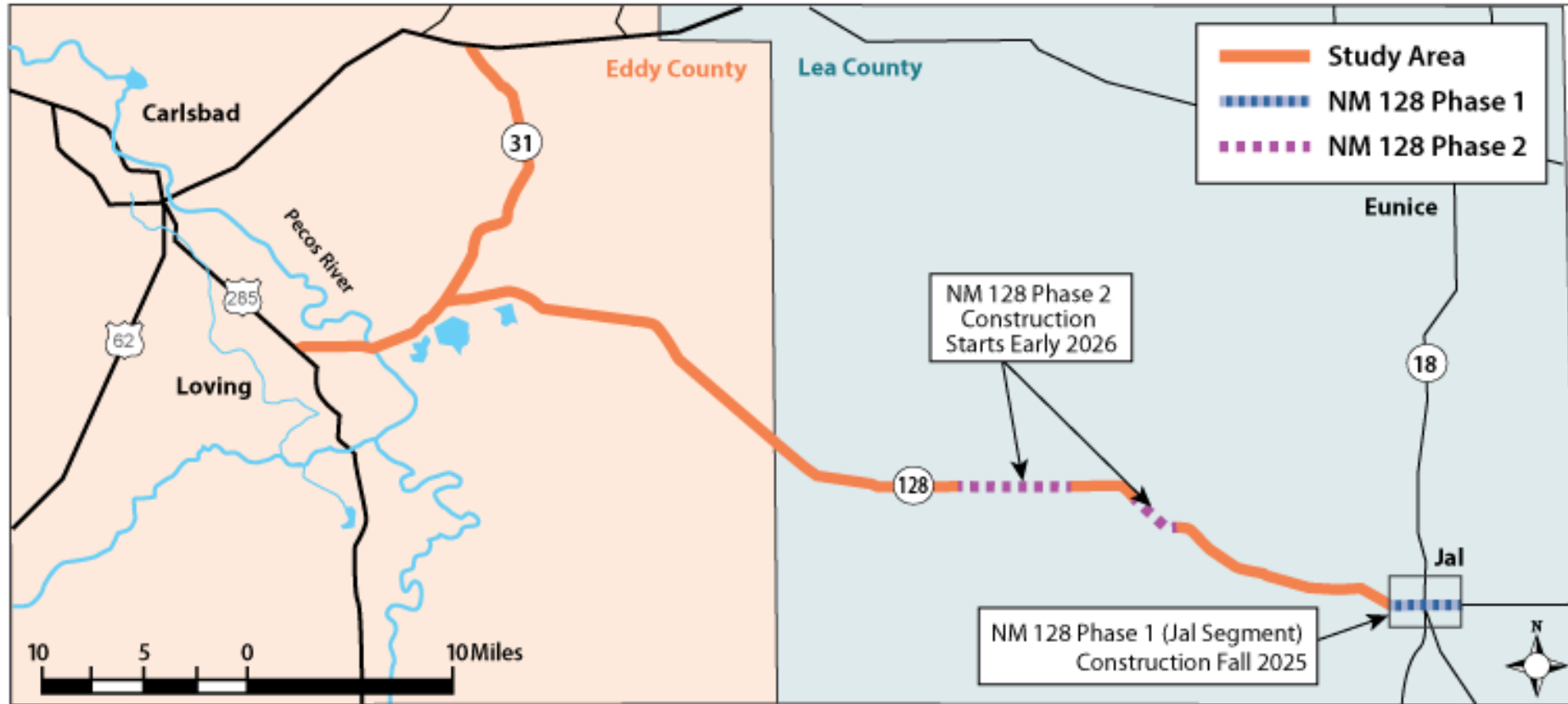

NM 128 Phases 1 and 2 Map
(Overall Study Area in Orange)

Project Map

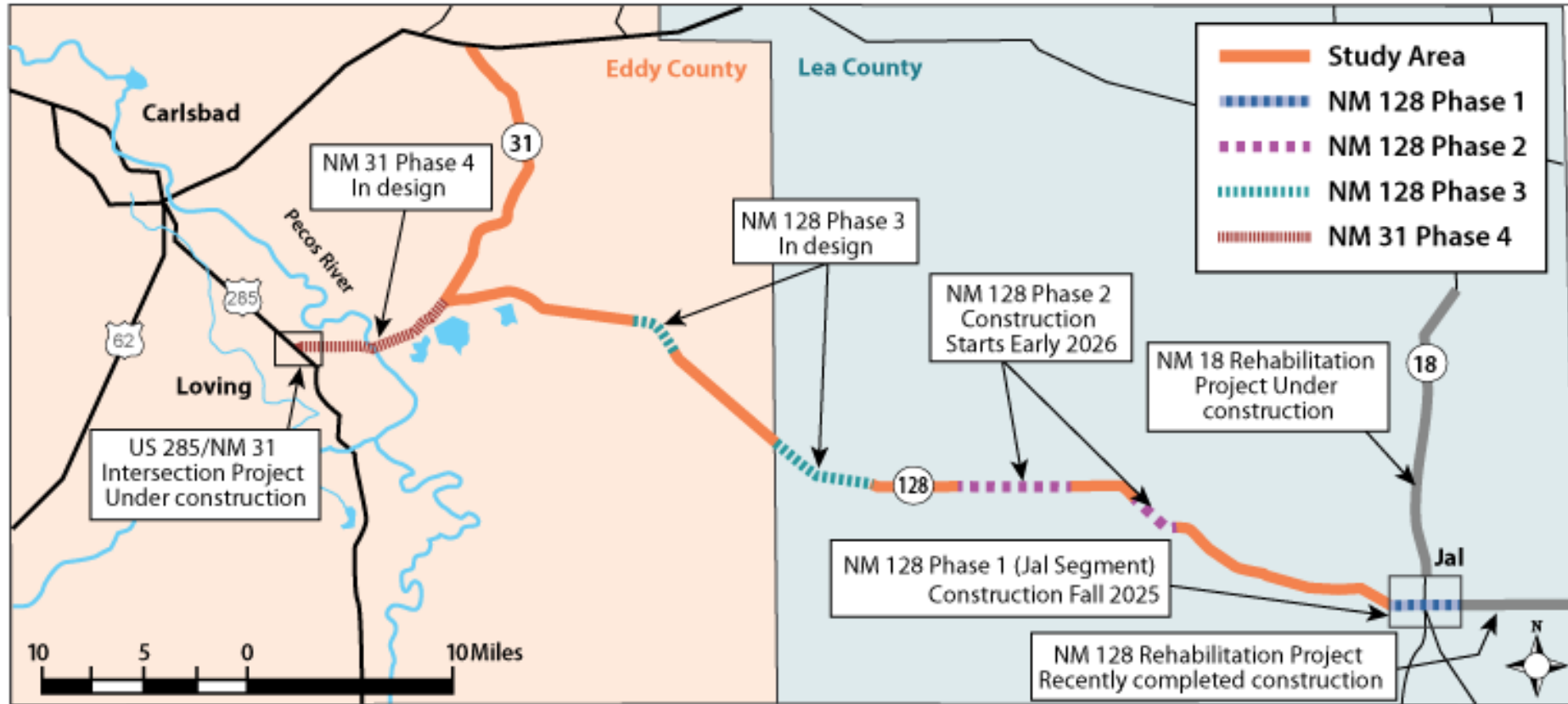

NM 128 and Adjacent Projects Map
(Overall Study Area in **Orange**)



Recap of Study and Project Background

Issues Identified in Study

- » Crashes – a lot
 - » Inadequate passing areas
 - » Conflicts at intersections
 - » Lack of turn lanes
 - » Narrow shoulders
- » Poor Traffic Flow
 - » High trucks/platooning
 - » Railroad crossings
- » Crumbling Pavement Condition
- » Drainage challenges
- » Unpermitted access points



Study Recommendations

- » Add turn lanes with **proper deceleration and storage lengths**.
- » Add a wide **median** for separation of EB/WB lanes.
- » Provide **passing areas** and additional capacity
- » Widen outside **shoulders** and add rumble strips.
- » Add **lighting** at intersections and conflict points.

NM 128 Economic Impact

- » Crude oil production
 - » NM accounts for 13% of total US (2nd largest state)
 - » 2012-2018 O&G in Eddy County supported 55K jobs and \$4.9B in labor income to NM's economy
 - » Nearly half of 2023 NM State General Fund revenue (\$7B)
- » Potash production
 - » NM ranks first in US production of potash (75%)
- » WIPP (Waste Isolation Pilot Plant)
 - » US's only deep geologic long-lived radioactive waste repository



Final Design for **NM 128 Phase 1 (Jal Segment)**

City of Jal (between Wyoming Rd. and Schooley Rd.)
Milepost 50.6 to Milepost 53.7

Project Limits

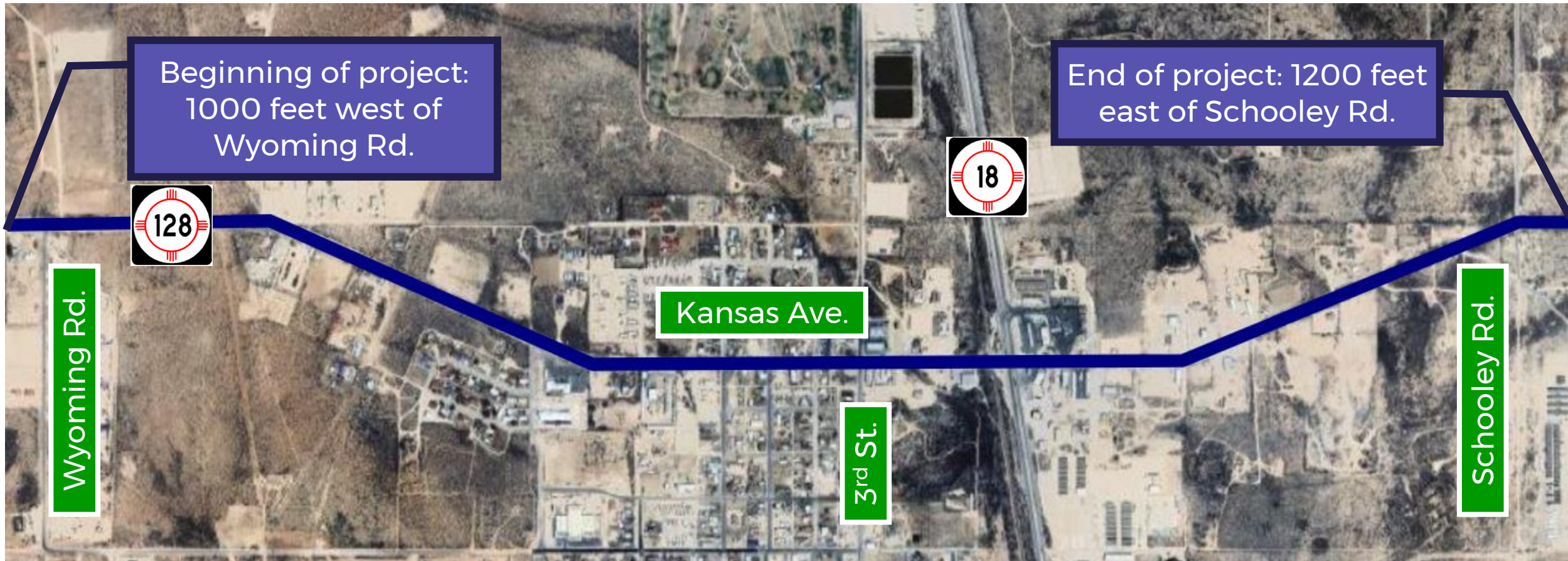

Typical Section in Jal

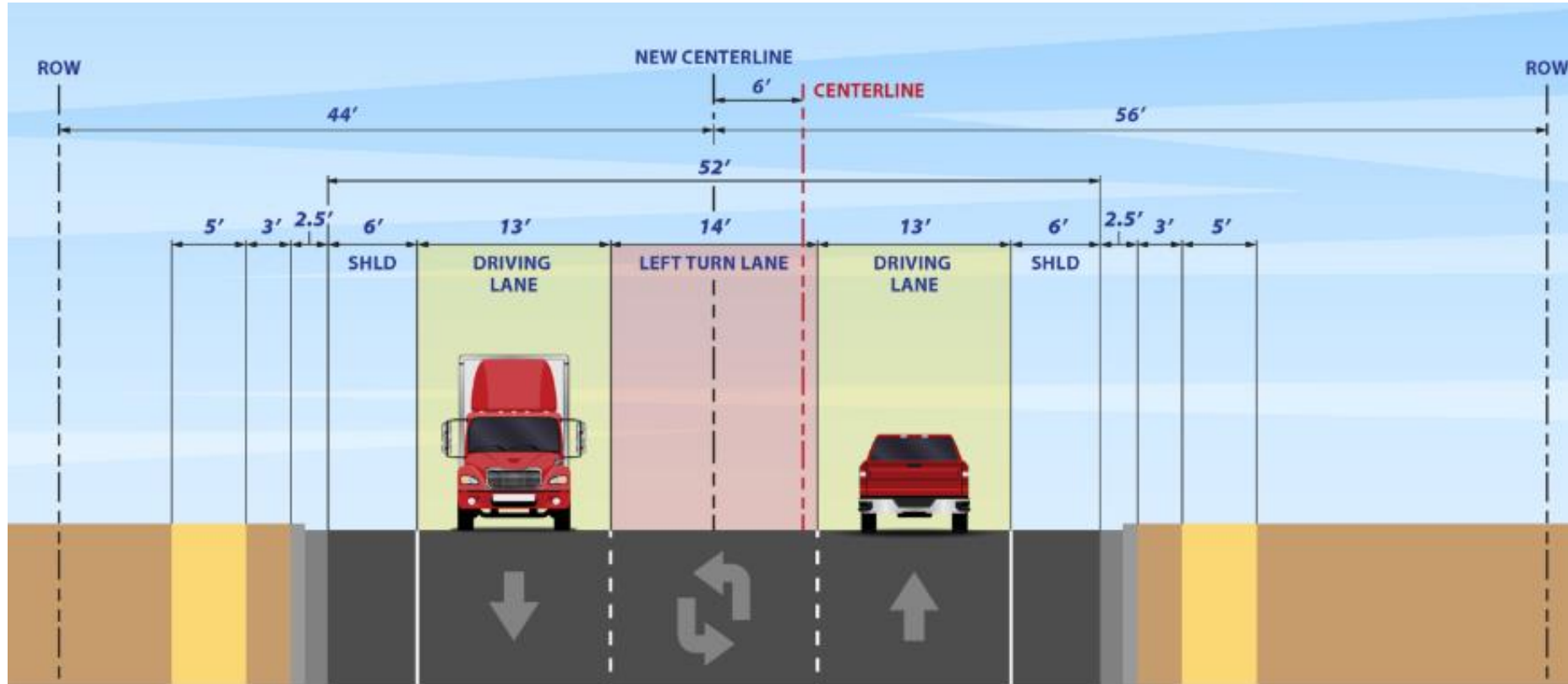

- » Includes widened section between 3rd St. and NM 18 for left and right turn lanes.

Construction Phasing



First phase – north side

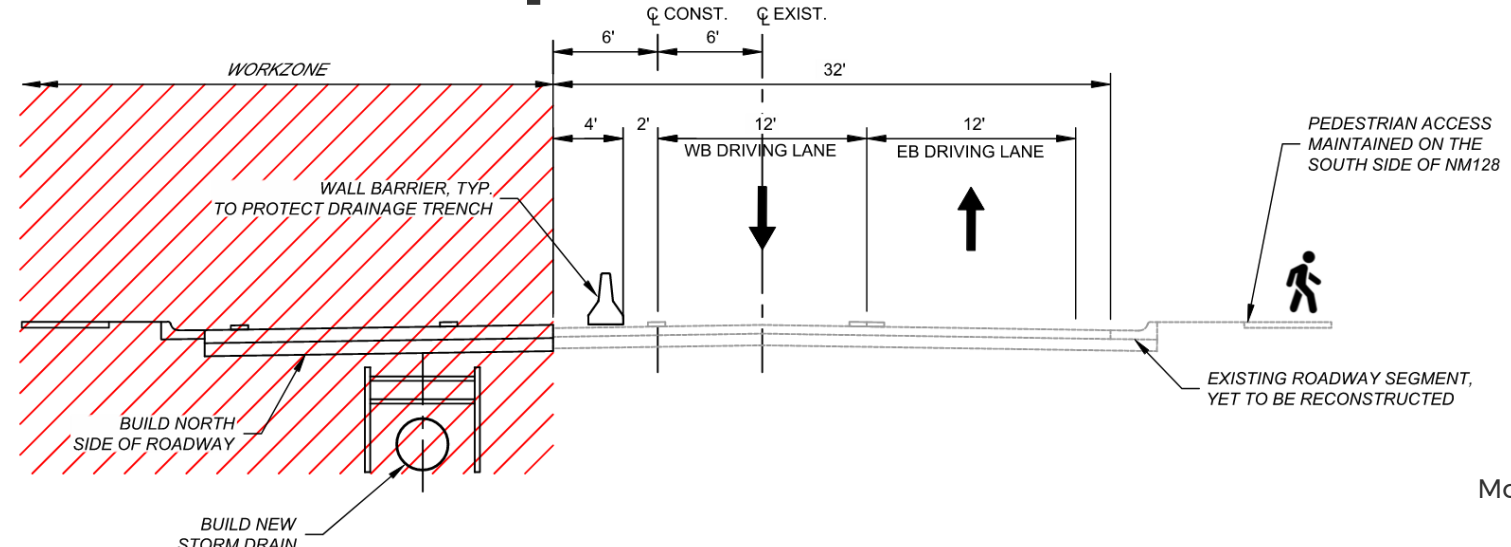

Construction Phasing



Second phase - middle

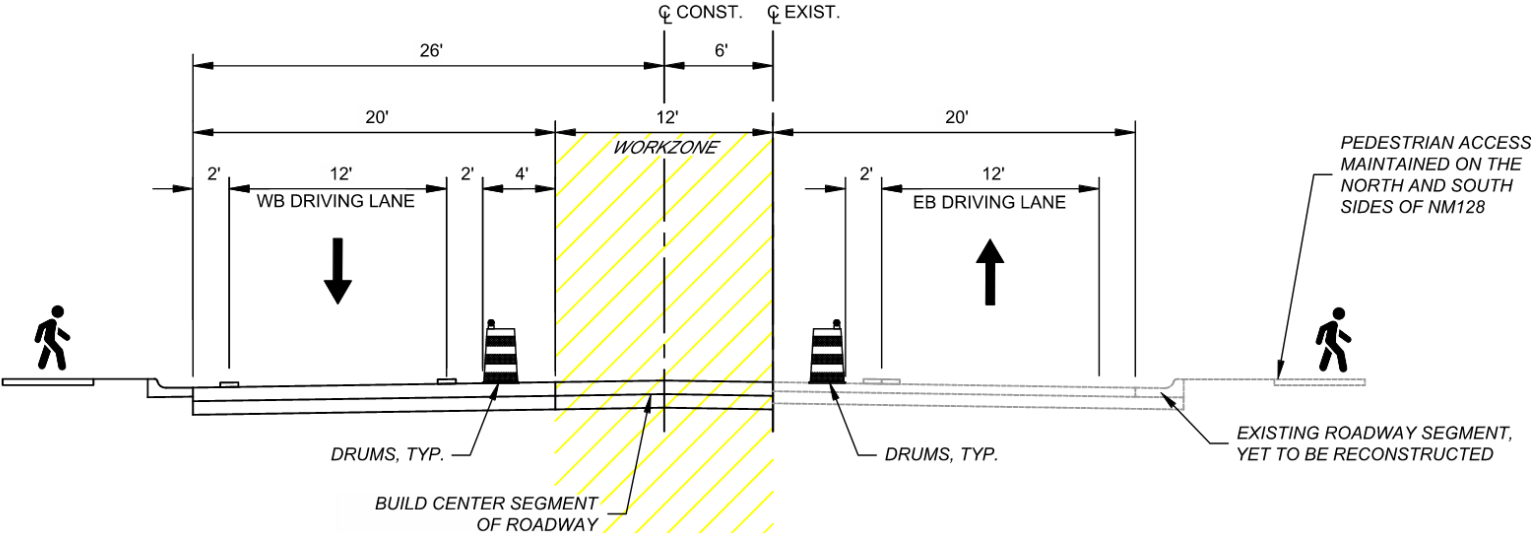

Construction Phasing



Third phase – south side

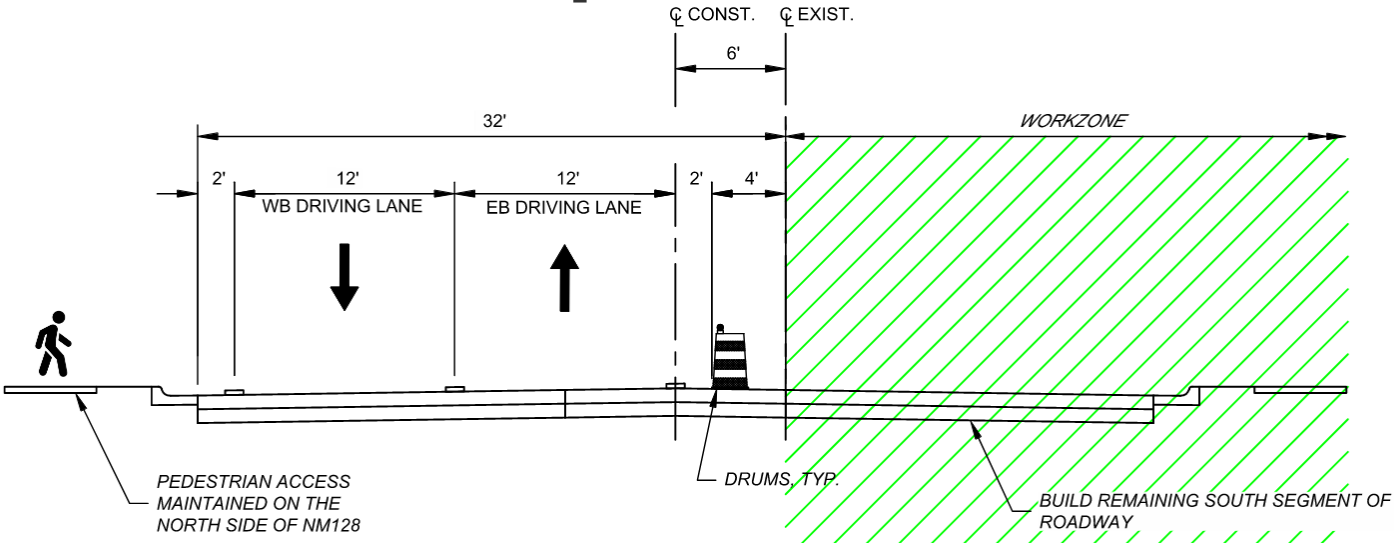

Access Management

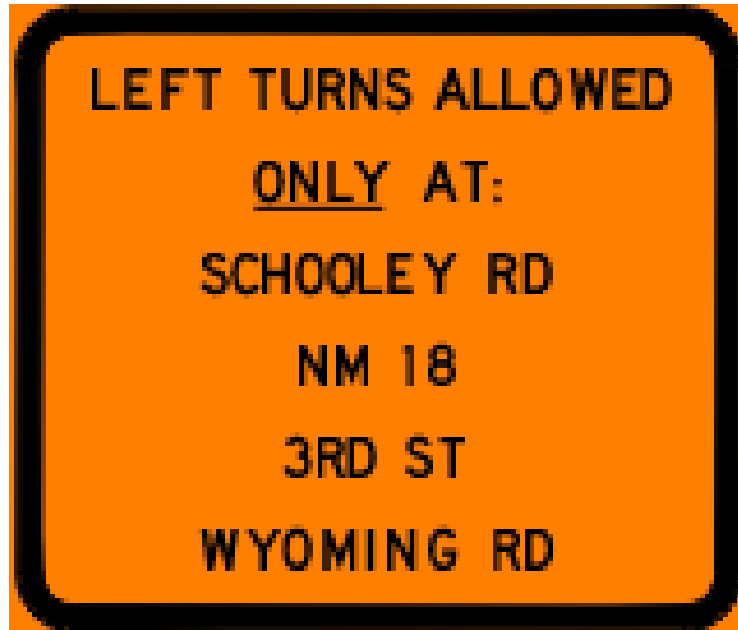

Railroad Crossing at NM 128/NM 18

- » The railroad crossing construction will result in a complete but temporary 3-5 day closure of NM 128 at the tracks.
- » Detour routes will be shared by the contractor prior to the railroad construction.
 - » May be different for eastbound and westbound
 - » Will be clearly signed

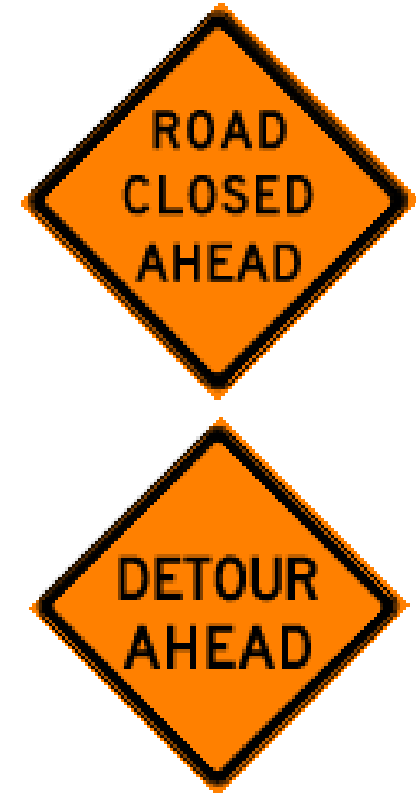

Railroad Crossing at NM 128/NM 18

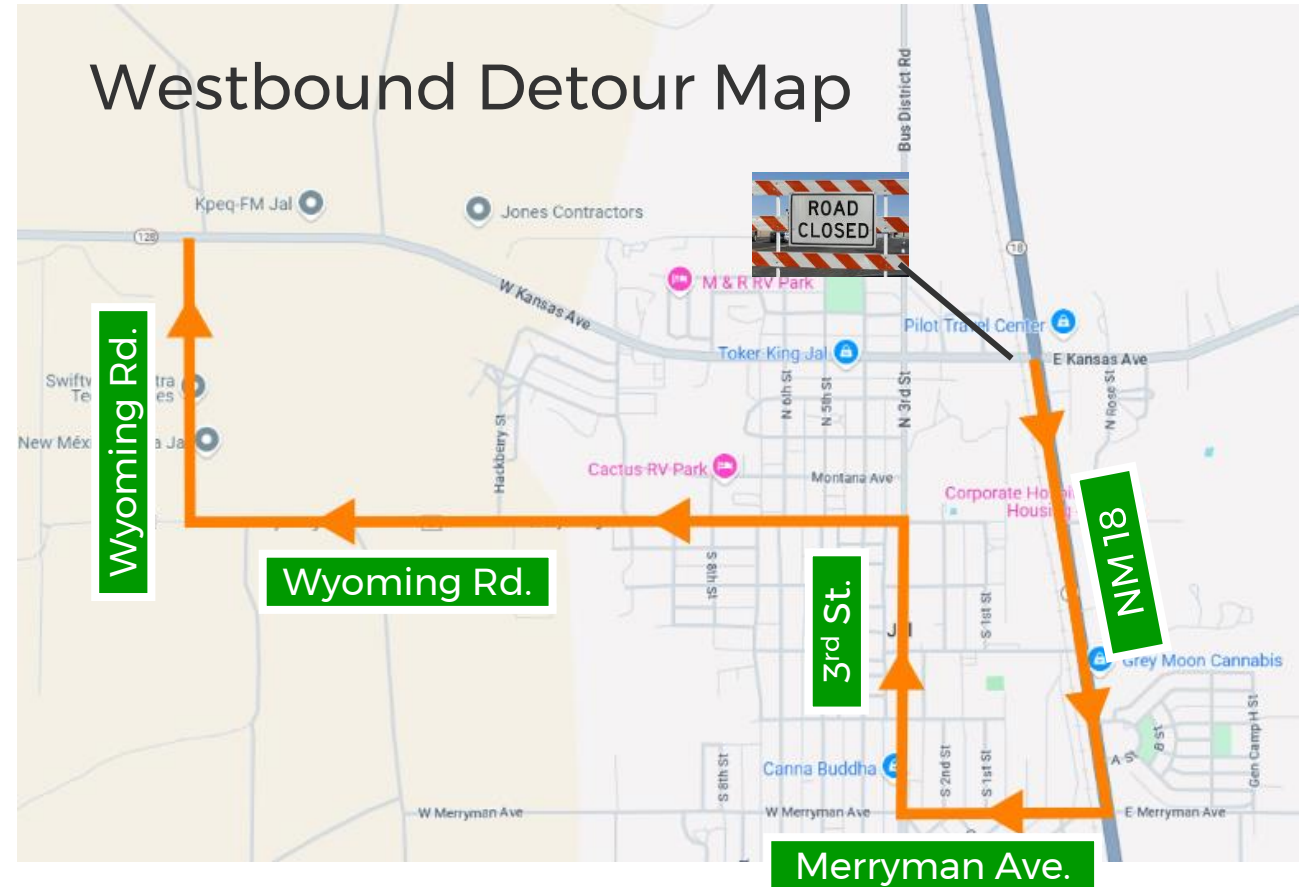
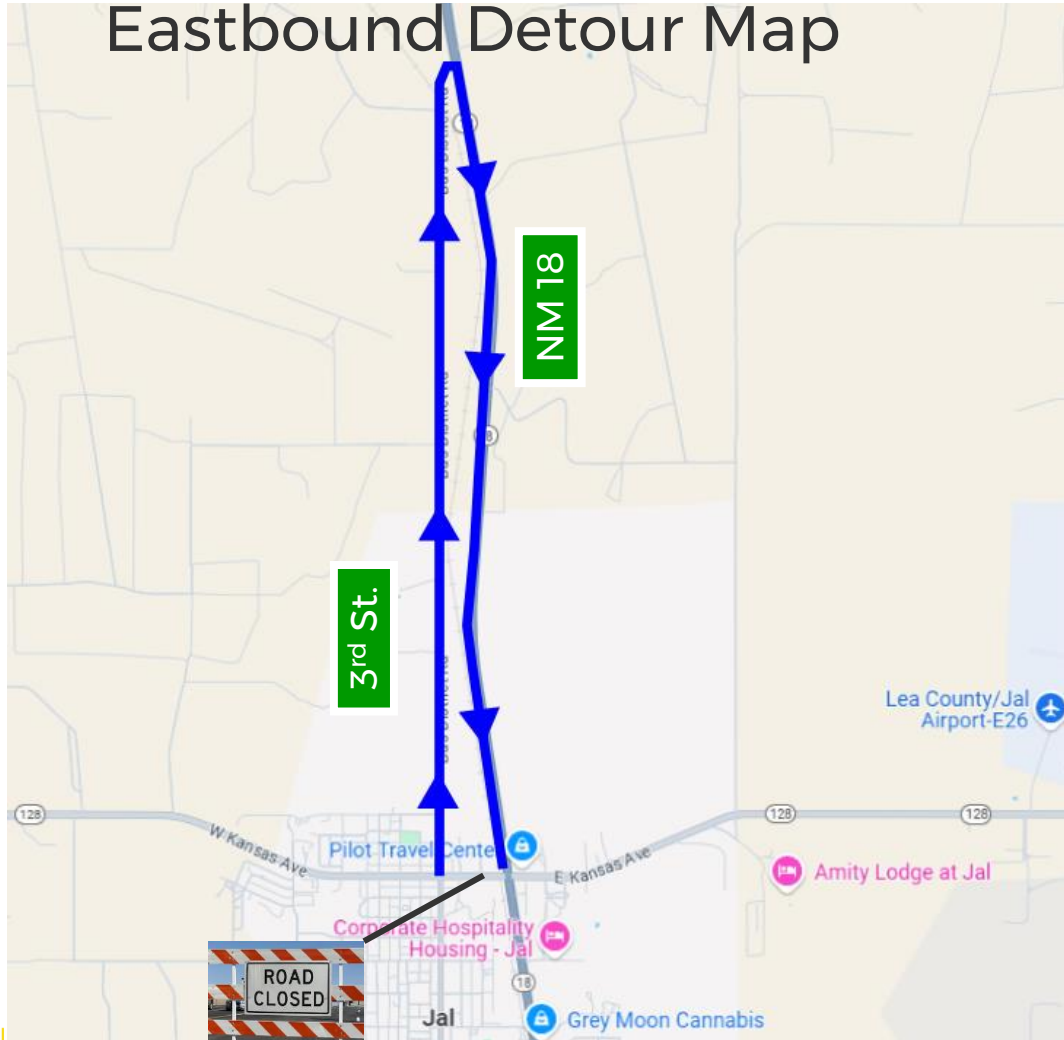



Final Design for NM 128 Phase 2

Brininstool/Diamond through Delaware Basin & the Battle Axe intersections
Milepost 26.9 to 32.75 and Milepost 36.5 to 39.35

New Divided Highway

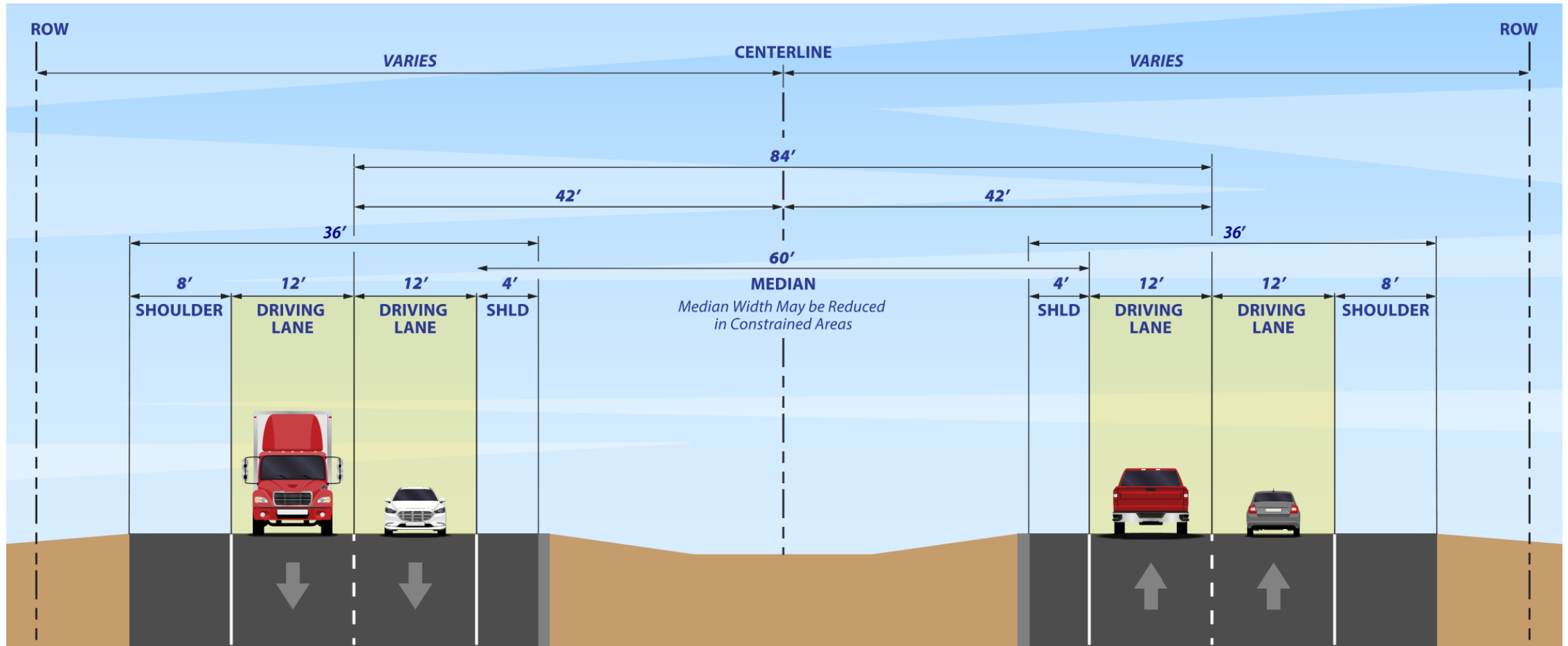

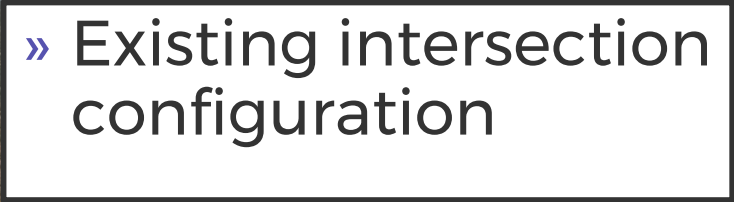

Major Intersections – High T



Graphical rendering of high-T intersection

Major Intersections – Full access

- » Brininstool Rd./Diamond Rd.
- » County Road Realignment

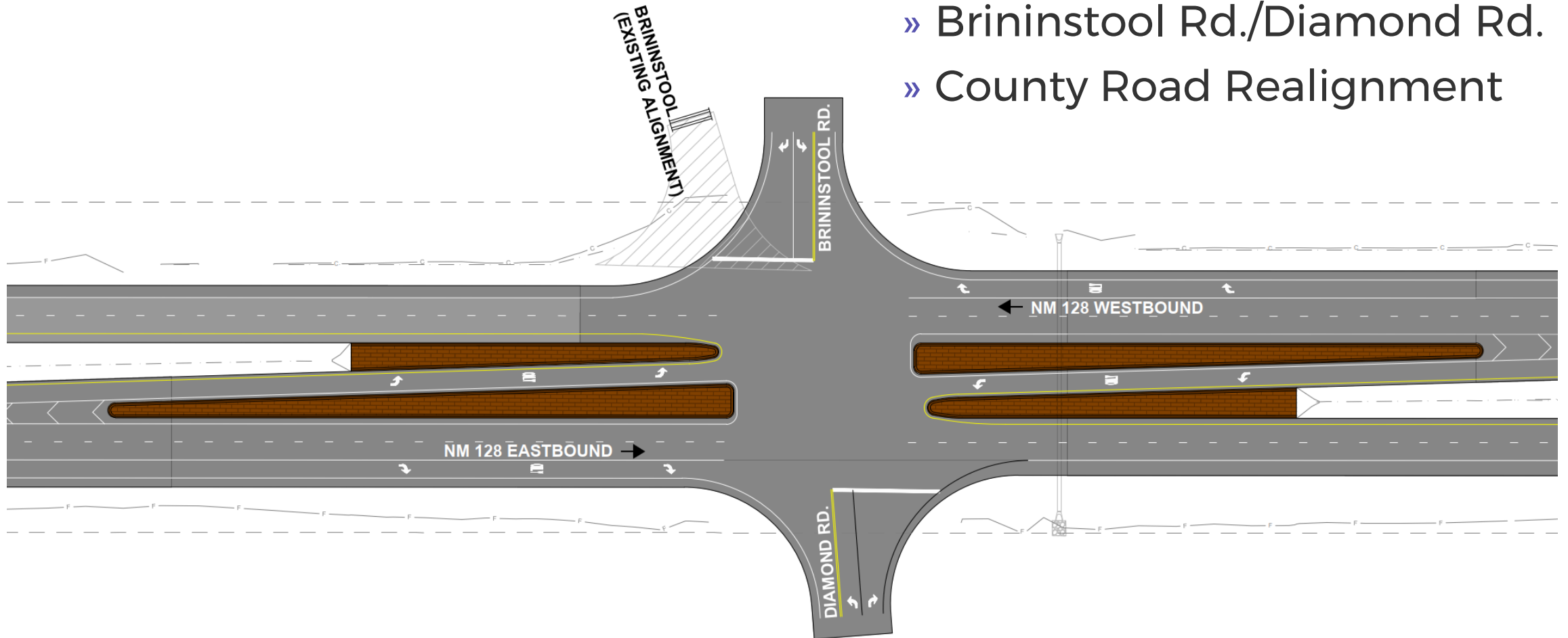

Minor Intersections

- » Oil and gas turnout design for off-tracking
- » U-turns across median

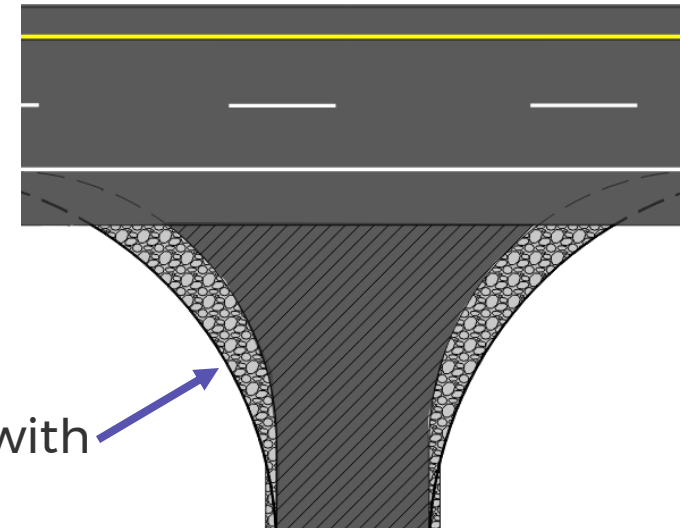

Example of turnout with extended shoulders

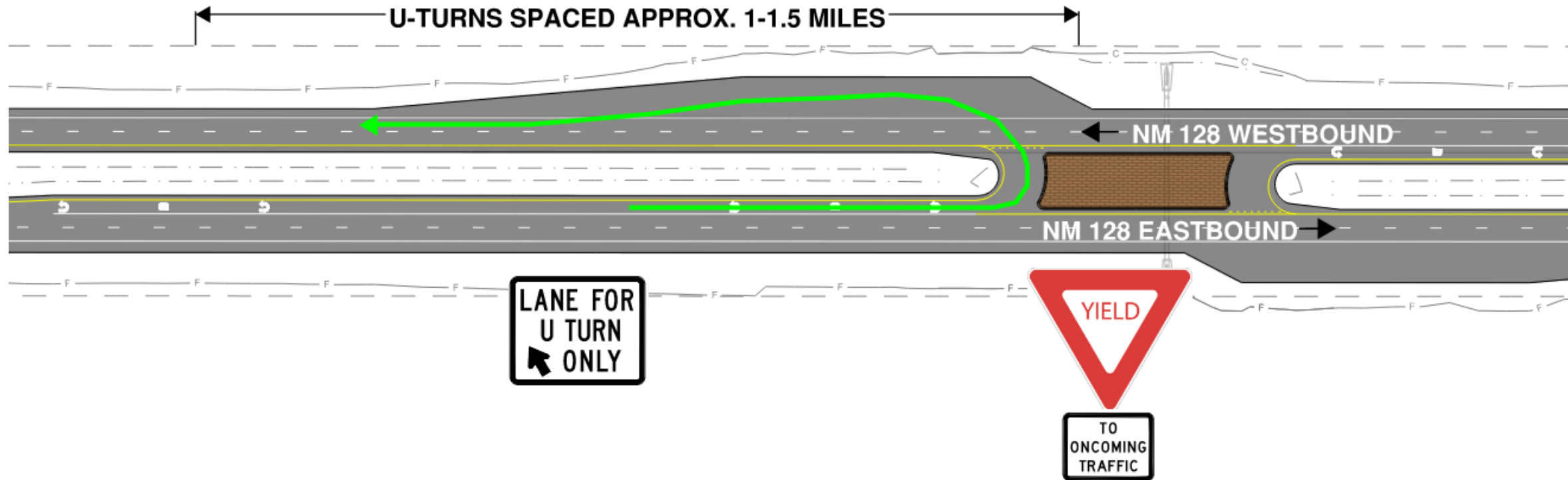

Bicycle Considerations

- » NM 128 is a designated facility according to NM State Bike Plan.
- » *Proposed shoulders provide width for bicycle use, and intersections will allow passage through a refuge area within the raised median.*

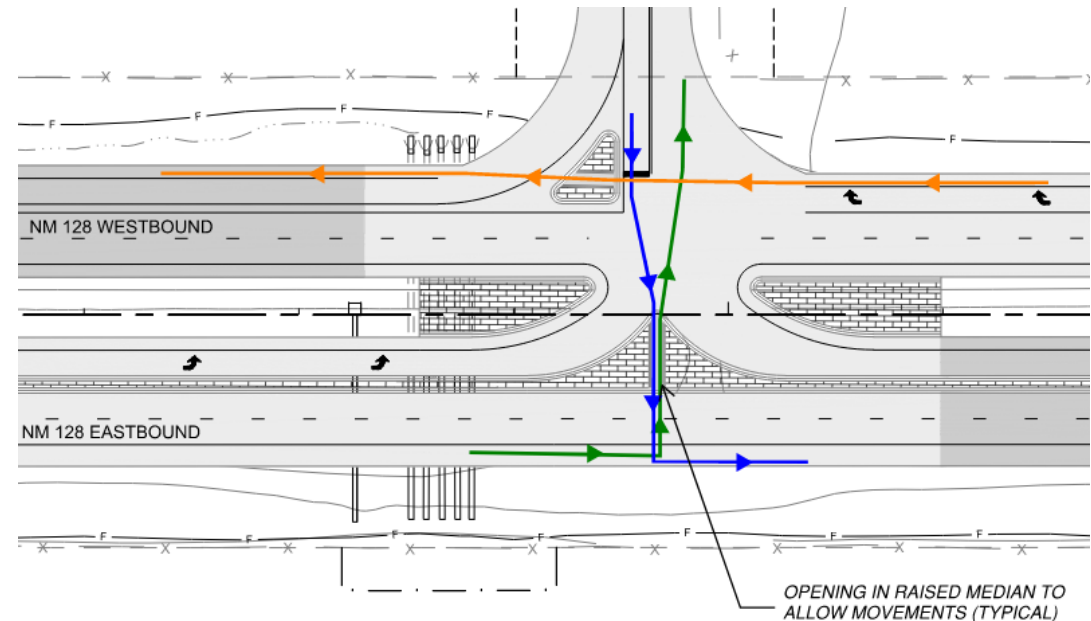
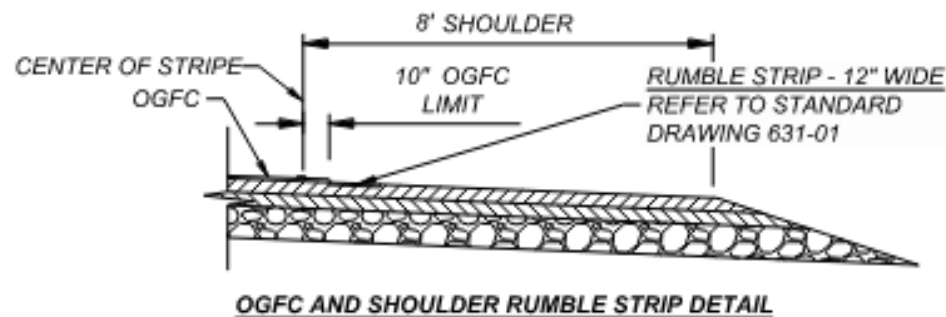

Pavement

- » “Full depth reclamation” process will be used on the existing pavement
 - » Rehabilitates existing pavement to new (or better) condition
 - » Faster, more efficient method for construction
 - » Takes advantage of existing infrastructure

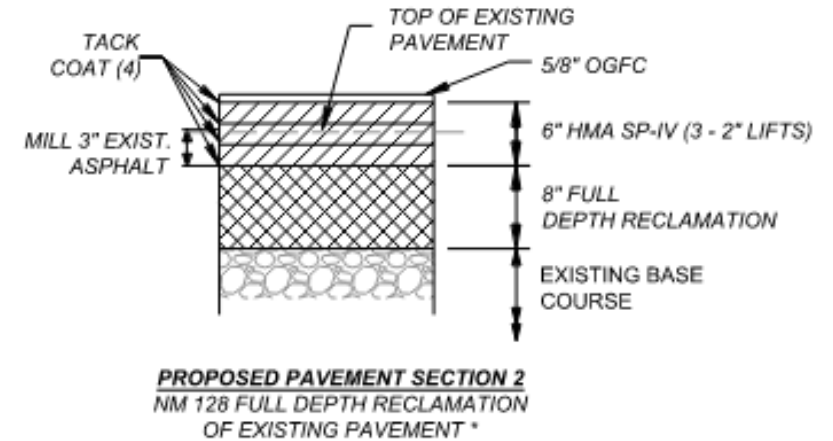

Construction Phasing

- » Two main phases allow for adjacent construction while traffic is maintained in existing condition.
- » Major intersections will be coordinated with each other to minimize disruptions and detours
 - » Access will be maintained through construction.



Construction Phasing

- » Two main phases allow for adjacent construction while traffic is maintained in existing condition.
- » Major intersections will be coordinated with each other to minimize disruptions and detours
 - » Access will be maintained through construction.

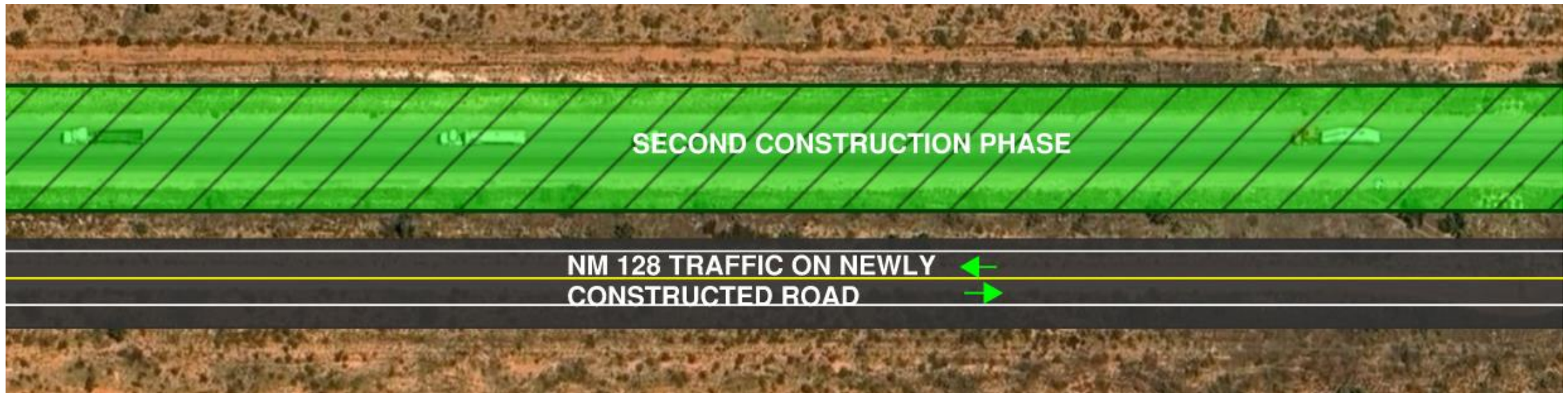

Utilities

- » Coordination with Utility Companies will be crucial to avoid costly delays to the construction schedule.
- » Fast lines routed through crossing culverts pose a risk, as the culverts lose capacity and the lines facilitate clogging.





Schedule and Next Steps

NM 128 Phase 1 and 2 Map

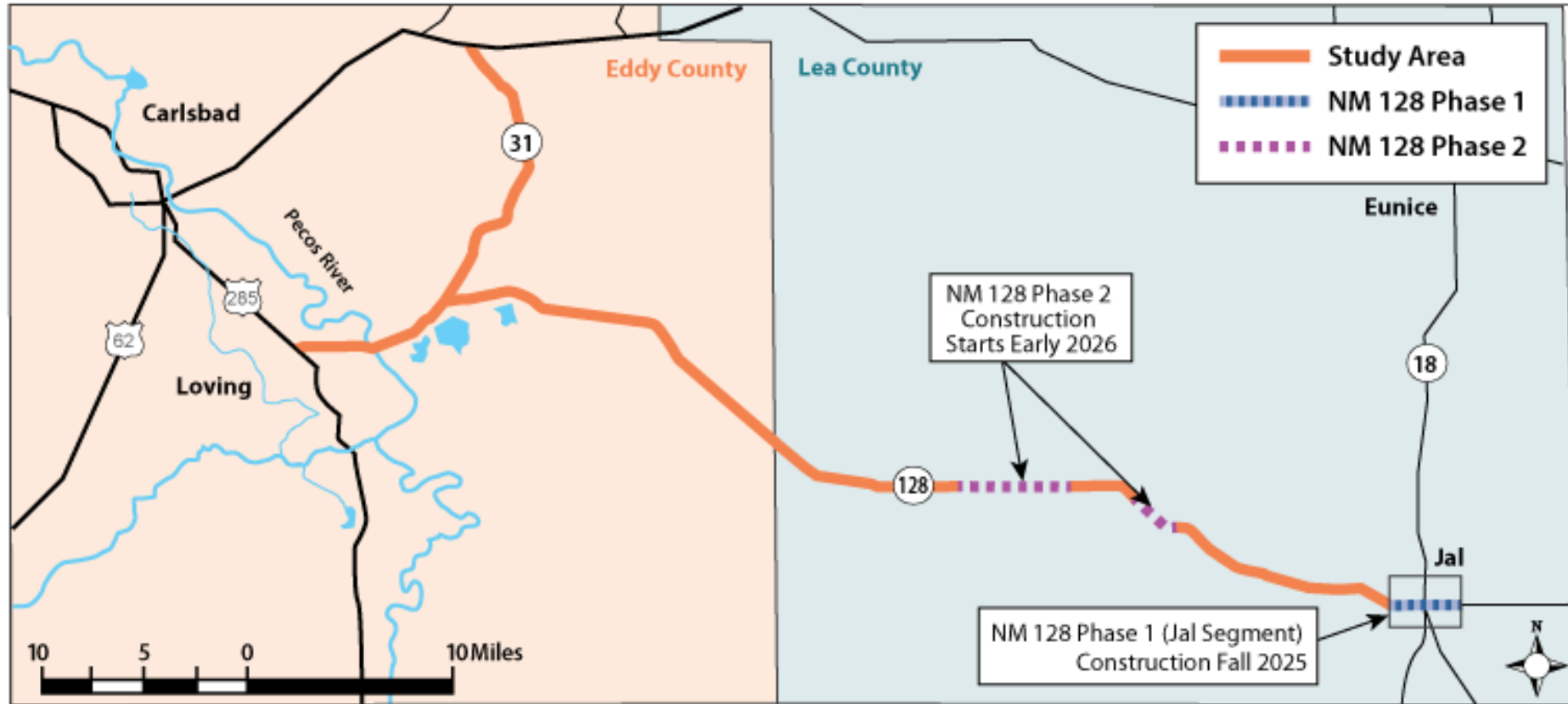

Schedule and Next Steps

- » Phase 1 Bids Due – **June 2025**
- » Phase 1 Construction Start - **Fall 2025**
- » Phase 2 Design Plans Complete – **Summer 2025**
- » Phase 2 Construction Start – **Early 2026**
- » *The construction contractors will engage the public with updates.*
- » *Additional design phases are in progress and will be shared with the public as they near completion and funding is identified.*

How to Comment

- » Submit your project-related comments before **May 18th, 2025**. Comments can be submitted through one or more of the following channels:
 - » **Email:** emily.engelbart@wsp.com
 - » **Comment form:** Available on project website www.nm31-128project.nmdotprojects.org
 - » **Mail:** C/O Emily Engelbart, Attn: NM 31-128, 2440 Louisiana Blvd. NE, Suite 400, Albuquerque, NM 87110
 - » **Phone:** 505-878-6554



Thank you!

Questions?



Emily Engelbart

 emily.engelbart@wsp.com

 505-878-6554

 2440 Louisiana Blvd. NE,
Suite 400, Albuquerque,
NM 87110

www.nm31-128project.nmdotprojects.org